

# SHANGRI-LA HOTEL, SINGAPORE MEETINGS & EVENTS FACT SHEET



## INTRODUCTION



Shangri-La Hotel, Singapore offers state-of-the-art function spaces complemented by a team of experienced event planners that cater to the highest level of international business, diplomatic and social gatherings. These can be found across its 5,500 square meters of MICE spaces concentrated in four different areas of the property: the lobby and mezzanine of the Tower Wing, third floor of the Valley Wing, and first floor of the Garden Wing.

Planners will delight in the two pillar-free ballrooms and 20 function rooms that offer a wide variety of settings. These include a series of 15 event spaces on level 4 of the Tower Wing that feature foldable partitions to accommodate 30 or 300 guests. Available are state-of-the-art conference facilities, including simultaneous translation services and intelligent lighting systems. Supporting every event is a dedicated team of catering and convention event service managers that will see to every want and need. It is complemented by a culinary team that can accede to any dietary request.

## CELEBRATIONS & WEDDINGS



The hotel also has the ideal venue for every special occasion, from weddings to milestone birthdays, anniversaries and baby showers. These include the double-storey Banyan Deck set in the garden, heritage building Dutch Pavilion, and 7-metre tall, open-air structure The Orchid. A dedicated team of catering and convention event managers is on hand to brainstorm creative ideas that will turn the celebration into something truly memorable.

Through the decades, countless couples have chosen to host their weddings in Shangri-La Hotel, Singapore. Defined by elegance and sophistication, the celebrations are fully customisable right down to the type of flower, ribbon and lace to adorn the event space. In addition to the pillar-less ballrooms, other unique venues are available to cater to a range of scales, from the grand to the intimate. Small function rooms on the mezzanine of the Tower Wing and outdoor pavilions can be reserved for the tea ceremony or solemnisation.

## ISLAND BALLROOM



Occupying an area of 1,469 square metres, the Island Ballroom can accommodate up to 1,000 people for cocktail receptions or banquets, and 1,400 people in a conference setting. Designed by internationally renowned Leese Robertson Freeman Designers, it is unique for its pillar-free construction that can also be segmented into individual sections for smaller events.

Expect state-of-the-art audio facilities and a new-age "smart lighting" system. Specially commissioned artwork, backlit marble walls and luxurious soft furnishings differentiate it from other function venues. The adjacent Island Foyer, with an area of 488 square metres, is ideal for hosting pre-dinner cocktails, coffee breaks and exhibitions. It also has a VIP holding room, making it suitable for state occasions. Having its own entrance means guests need not pass through the hotel lobby to access the Island Ballroom.

## TOWER BALLROOM



Dating back to when Shangri-La Hotel, Singapore opened in 1971, the Tower Ballroom has set the benchmark for iconic events held at Shangri-La hotels around the world. It is pillar-free and covers an area of 934 square metres with a dramatic ceiling height of 5.8m. It can accommodate 680 people for banquets and 900 people for theatre-style conferences and conventions.

Also designed by Leese Robertson Freeman Designers, the Ballroom exudes luxurious elegance in the calm, neutral colours of beige, blue and silver. The chinoiserie-themed silk wall art is handmade by Fromental in the UK, depicting a scene of a garden that blends European artistic styles with Chinese influences. The Ballroom is equipped with the latest audio-visual equipment and screen displays. Sixty adjustable spotlights allow specific focus on different areas, and 12 coloured alcove lights enhance the ballroom's mood for each occasion.

## GARDEN WING VENUES

The Garden Wing houses three function areas: Banyan Deck, Garden Terrace and Dutch Pavilion, each surrounded by lush gardens with outdoor decks.

### BANYAN DECK



Nestled in the shade of mature trees, the Banyan Deck is ideal for hosting a cocktail reception under the stars, and garden-themed solemnisations and weddings.

Spanning over 80 square metres with an upper and lower deck, the entire Banyan Deck is made from Malaysian balau wood using a traditional construction style, which uses no nails or screws. Each plank is cut to shape and slotted in to fit perfectly like pieces of a jigsaw puzzle.

### GARDEN TERRACE



Surrounded by tropical greenery, the Garden Terrace measures 322 square metres and is situated near the pool. It has its own kitchen and is capable of hosting corporate celebrations of up to 180 people, or a cocktail reception in the evening for a maximum of 200 guests.

## DUTCH PAVILION



A heritage building dating from the 1920s, it was part of Singapore's first Dutch school. The Hollandse School opened in 1928 and the Dutch Pavilion used to serve as a hall for physical education, assembly and classes. At its peak in 1958, the Hollandse School had 221 students. In 1982, the land was sold to Shangri-La Hotel, Singapore after the school shifted to bigger premises.

The Dutch Pavilion underwent a S\$2 million renovation in 2015, led by Leese Robertson Freeman Designers. Original structures such as the wall and distinctive gable roofs were retained. Interior walls and soft furnishings in a calming white, blue and silver palette were added. A new outdoor terrace fitted with an outdoor grill was installed to enhance the culinary experience for events held here.

With an area of 138.5 square metres and a ceiling height of 3.6m, the Dutch Pavilion can accommodate up to 100 guests in banquet-style, or host 120 guests for a cocktail reception. Fitted with glass windows and doors all around, it is filled with natural light in the day. In the evening, it is the perfect venue for al fresco cocktail receptions and dinners.



## TOWER WING MEZZANINE



The newly-renovated Tower Wing has 15 event spaces on level 4. Designed by Bond Studio from Tokyo with wood and woven rattan accents, they exude a calm and soothing ambience.

Each room is named after indigenous flowers and feature foldable partitions to lend flexibility to any meeting requirement for 30 to 300 guests. The Orchid, Hibiscus and Peony rooms have natural lighting with floor-to-ceiling glass windows, while the Lotus room has its own foyer space with an ultra-short throw projection wall.

In the middle of the mezzanine is the lounge, an open and versatile space where guests can take find respite, have small breakout meetings, eat breakfast or enjoy cocktails.



# MEZZANINE LEVEL

Venue	Capacity & Setup Style						Dimensions (m)	Area (sqm)	Ceiling (m)
	Reception	Theatre	Banquet	Classroom	Cluster	U-Shape			
Azalea	300	408	220	207	154	117	38.4 x 9.2	353.3	2.3
Azalea I	70	96	50	45	35	33	11.7 x 9.2	107.6	
Azalea II	100	120	90	63	63	39	13.6 x 9.2	125.1	
Azalea III	100	120	90	54	63	33	13.1 x 9.2	120.5	
Azalea I & II	200	264	140	126	98	75	25.3 x 9.2	232.8	
Azalea II & III	220	288	160	135	112	81	26.7 x 9.2	245.6	
Orchid	100	136	80	66	56	51	20.4 x 5.2	106	Low: 2.2 Alcove: 3.7
Orchid I	30	16	20	12	14	9	3.9 x 5.2	20.3	
Orchid II	50	40	30	24	21	15	8.4 x 5.2	43.7	
Orchid III	50	40	30	24	21	15	8.1 x 5.2	42	
Orchid I & II	60	72	50	36	35	27	12.3 x 5.2	64	
Orchid II & III	80	112	60	60	42	39	16.5 x 5.2	85.8	
Hibiscus	200	300	200	150	140	123	41.2 x 5.7	234.8	Low: 2.2 Alcove: 3.7
Hibiscus I	100	104	80	54	56	39	16.4 x 5.7	93.5	
Hibiscus II	60	72	50	36	35	27	12.6 x 5.7	71.8	
Hibiscus III	60	72	50	36	35	27	12.2 x 5.7	69.5	
Hibiscus I & II	150	200	140	102	98	81	29 x 5.7	165.3	
Hibiscus II & III	120	160	110	84	77	69	29 x 5.7	141.4	
Peony	120	144	100	66	70	51	20.8 x 5.8	120.6	Low: 2.2 Alcove: 3.7
Peony I	40	40	30	18	21	9	8.2 x 5.8	47.6	
Peony II	60	72	50	36	35	27	12.6 x 5.7	73	
Lotus	120	168	80	81	56	42	17 x 7.7	131	2.3
Lotus I	60	60	40	27	28	18	8.5 x 7.7	65.5	
Lotus II	60	60	40	27	28	18	8.5 x 7.7	65.5	
Gardenia	80	120	60	54	42	36	12.9 x 7.1	91.6	2.2
Boardroom	-	-	-	-	-	-	10.4 x 5.8	60.3	2.7

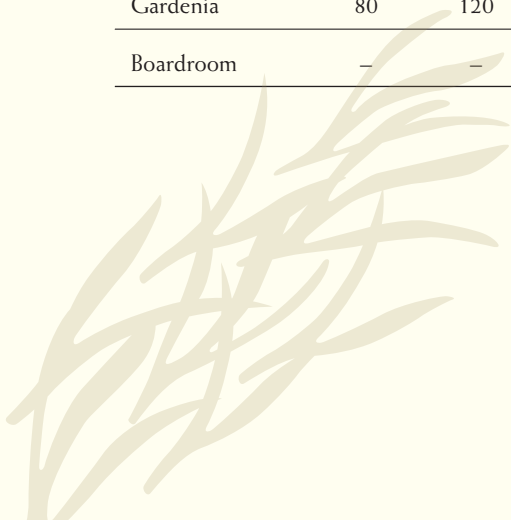

## EVENT SPACES CAPACITY

Venue	Capacity & Setup Style						Dimensions (m)	Area (sqm)	Ceiling (m)
	Reception	Theatre	Banquet	Classroom	Cluster	U-Shape			
Island Ballroom	1,200	1,400	1,000	960	–	–	26.3 x 51.6	1,357	7.9
Island A	600	700	520	450	–	–	26.3 x 26.8	705	7.9
Island B	500	650	520	450	–	–	26.3 x 24.8	652	7.9
Jurong	300	400	270	242	–	–	26.3 x 15.8	416	7.9
Tanglin	330	450	270	286	–	–	25.3 x 9.2	473	7.9
Katong	330	450	270	264	–	–	26.3 x 17.8	468	7.9
Jurong / Tanglin	600	650	650	570	–	–	26.3 x 33.8	889	7.9
Tanglin / Katong	600	650	650	570	–	–	26.3 x 35.8	942	7.9
Island Foyer	–	–	–	–	–	–	13.8 x 42	580	3.8
Tower Ballroom	680	900	590	648	–	–	24.7 x 37.8	934	5.8
Tower A	350	380	300	312	–	–	24.7 x 18.8	464	5.8
Tower B	350	380	300	336	–	–	24.7 x 19	469	5.8
Casuarina	220	240	160	154	–	–	24.7 x 11.5	284	5.8
Acacia	250	320	220	220	–	–	24.7 x 14.7	363	5.8
Banyan	220	240	160	154	–	–	24.7 x 11.7	289	5.8
Casuarina / Acacia	500	600	380	330	–	–	24.7 x 26.2	647	5.8
Acacia / Banyan	500	600	380	330	–	–	24.7 x 26.4	652	5.8
Tower Foyer	–	–	–	–	–	–	10.4 x 34.1	337	3.6
State Room	60	80	50	36	–	–	11.4 x 8.7	101	3.4
Summit Room	60	–	50	–	–	–	10.0 x 10.0	100	4.5
Garden Terrace	130	120	120	54	–	–	27.0 x 18.0	486	2.75
Dutch Pavilion	120	100	100	70	–	–	31.0 x 9.5	264	4.0
Banyan Deck	160	–	–	–	–	–	–	240	–

For Banquet set-up, all tables used are 5ft round tables.  
 For Island Ballroom, a stage of 32' x 16' is catered for.  
 For Tower Ballroom, a stage of 24' x 12' is catered for.

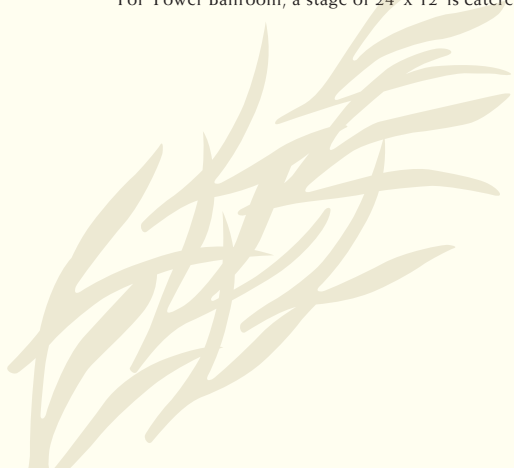

# ISLAND / TOWER BALLROOM

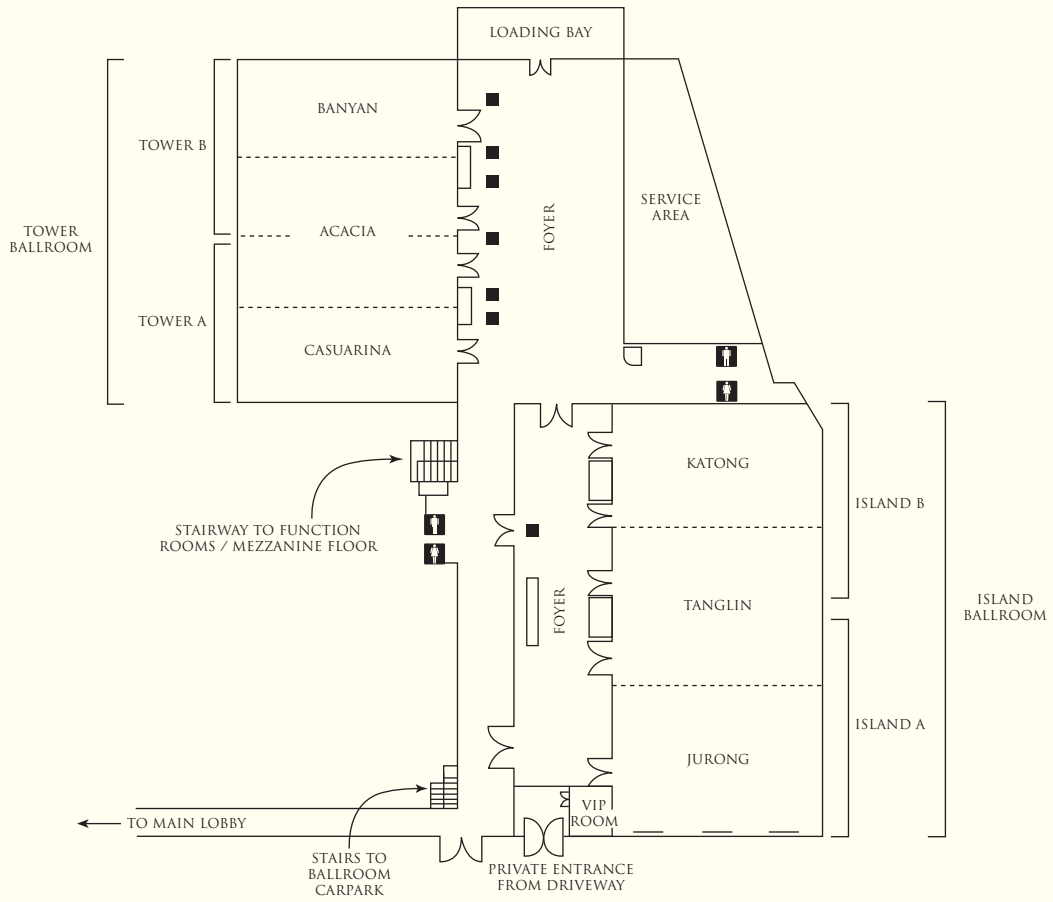

# MEZZANINE FLOOR

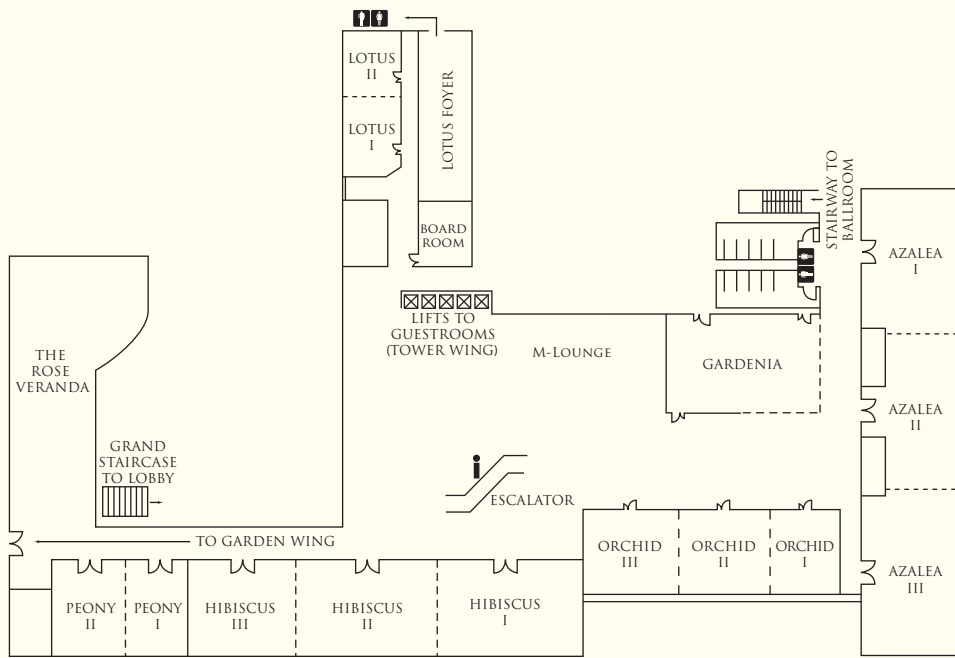

DUTCH PAVILION

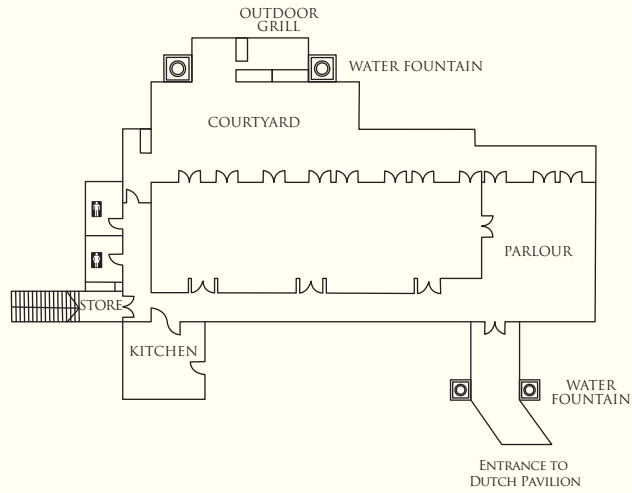

GARDEN TERRACE

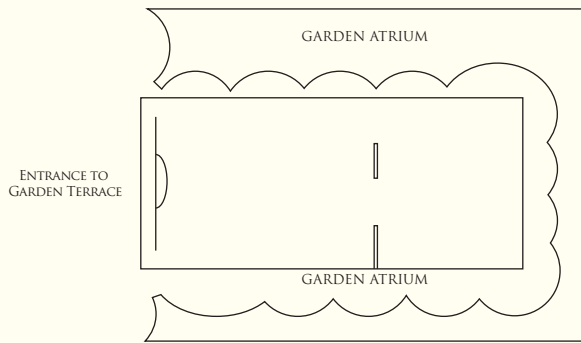

BANYAN DECK

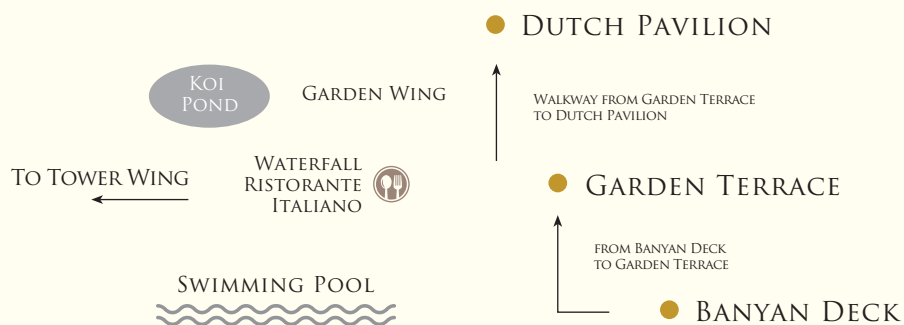
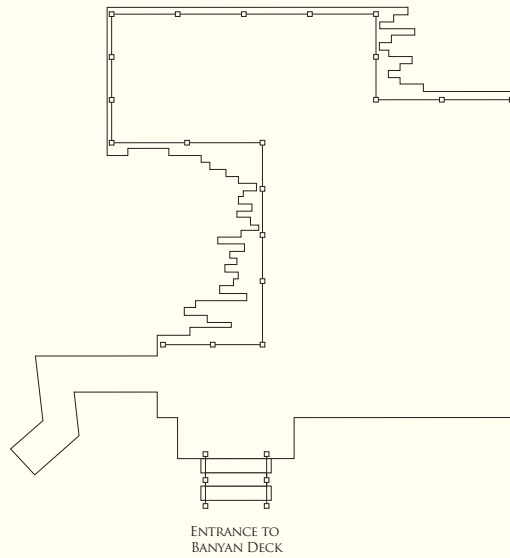



**Shangri-La hotel**

SINGAPORE

22 Orange Grove Road, Singapore 258350 Tel: (65) 6737 3644  
Website: [www.shangri-la.com](http://www.shangri-la.com) Email: [sls@shangri-la.com](mailto:sls@shangri-la.com)